

Diagrams 46_0841 TRIM PANEL PARTS - MOUNTING PARTS

Series: K25 R1200 GS

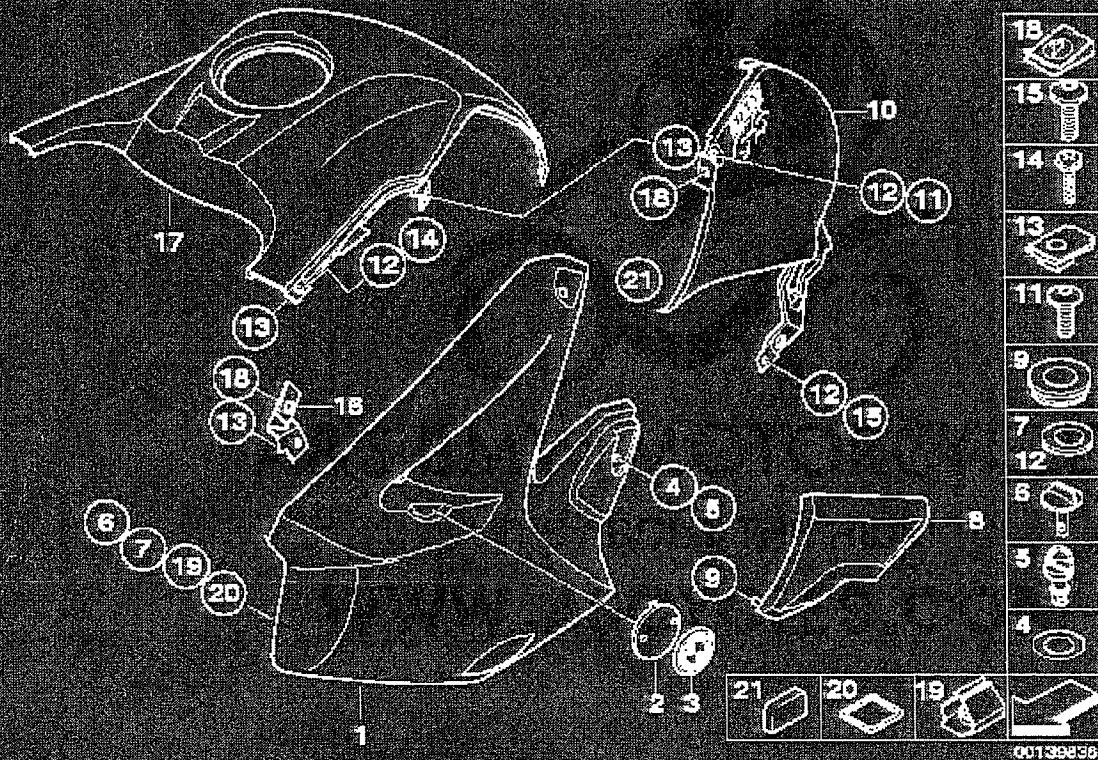

No	Description	Supplement	Qty	From	Up To	Part Number	AT	R	Tf
2	PLAQUE HOLDER, LEFT		1			46 63 7 672 095			
2	PLAQUE HOLDER, RIGHT		1			46 63 7 672 096			
3	BADGE	D=50MM	2			51 14 8 164 924			
4	CIRCLIP		8			51 71 0 301 833			
5	QUICK-RELEASE SCREW		4			46 63 7 676 995			
6	ROTARY KNOB		2			46 63 7 684 303			
7	WASHER, PLASTIC	D=25	4			46 63 7 684 306			
8	SIDE COVER, LEFT								
8	SIDE COVER, LEFT	SCHWARZ	1			46 63 7 677 515			
8	SIDE COVER, RIGHT	SCHWARZ	1			46 63 7 677 516			
9	RUBBER GROMMET		4			46 63 1 453 144			
10	TANK TRIM PANEL, LEFT								
10	TANK TRIM PANEL, LEFT		1			46 63 7 684 485			
10	TANK TRIM PANEL, RIGHT		1			46 63 7 684 486			
11	FLANGED CAP SCREW	5X16	4			46 63 7 686 286			
12	FLAT WASHER		4			46 61 2 308 594			
13	NUT	M5	4			52 53 2 308 647			
14	FLANGED CAP SCREW	M5X16	2			46 63 2 325 998			
15	FILLISTER HEAD SCREW	M5X14 SW	2			46 63 2 351 658			
16	LEFT TRIM PANEL BRACKET								
16	LEFT TRIM PANEL BRACKET		1			46 63 7 673 909			
16	RIGHT TRIM PANEL BRACKET		1			46 63 7 673 910			
17	COVERING FUEL TANK								
17	COVERING FUEL TANK	FELSROT - UMT	1			46 63 7 680 618			
17	COVERING FUEL TANK	WÜSTENGELB-I	1			46 63 7 680 619			
17	COVERING FUEL TANK	OZEANBLAU-ME	1			46 63 7 680 620			
18	C-CLIP NUT		4			46 63 7 676 994			
19	TRIM PANEL CLIP		2			46 63 7 684 304			
20	FRAME		2			46 63 7 684 305			
21	EDGE PROTECTION, TANK TRIM PANEL	SCHWARZ	2			46 63 7 684 367			